



Bid Notice Abstract

Request for Quotation (RFQ)

Reference Number 12881860
Procuring Entity CARLOS HILADO MEMORIAL STATE UNIVERSITY
Title Procurement of Labor and Materials for the Enhancement of Student Park at Fortune-Towne Campus
Area of Delivery Negros Occidental

Solicitation Number:	RFQ 26-089	Status	Pending
Trade Agreement:	Implementing Rules and Regulations	Associated Components	2
Procurement Mode:	Negotiated Procurement - Small Value Procurement (Sec. 53.9)	Bid Supplements	0
Classification:	Civil Works	Document Request List	0
Category:	Construction Projects	Date Published	27/03/2026
Approved Budget for the Contract:	PHP 250,000.00	Last Updated / Time	26/03/2026 08:49 AM
Delivery Period:	60 Day/s	Closing Date / Time	31/03/2026 09:00 AM
Client Agency:			
Contact Person:	Rowena De la Vida Prado Administrative Assistant II Mabini Street Talisay City Negros Occidental Philippines 6115 63-34-7120005 Ext.142 63-939-9296624 bac.sec@chmsu.edu.ph		

Description

Republic of the Philippines
 CARLOS HILADO MEMORIAL STATE UNIVERSITY
 Talisay City, Negros Occidental
 Mobile Phone Number: (0920) 583 3046
 bac.sec@chmsu.edu.ph

REQUEST FOR QUOTATION
 Page 1 of 4
 Date: MARCH 25, 2026
 Quotation No. 26-089

Please quote your lowest price on the item/s listed below, stating the shortest time of delivery and submit your quotation duly signed by your representative not later than _____ in the return envelope attached herewith.

DR. MA. RIZA T. MANALO
 BAC Chairperson

NOTE:

- ALL ENTRIES MAY BE TYPEWRITTEN OR LEGIBLY HANDWRITTEN
- DELIVERY PERIOD WITHIN 60 CALENDAR DAYS
- WARRANTY SHALL BE FOR A PERIOD OF SIX (6) MONTHS FOR SUPPLIES & MATERIALS, ONE (1) YEAR FOR EQUIPMENT, FROM DATE OF ACCEPTANCE BY THE PROCURING ENTITY

4. PRICE VALIDITY SHALL BE FOR A PERIOD OF _____ CALENDAR DAYS
5. G-EPS REGISTRATION CERTIFICATE SHALL BE ATTACHED UPON SUBMISSION OF THE QUOTATION
6. BIDDERS SHALL SUBMIT ORIGINAL BROCHURES SHOWING CERTIFICATIONS OF THE PRODUCT BEING OFFERED

ITEM DESCRIPTION OF WORKS QTY. UNIT MATERIAL COST LABOR COST TOTAL COST
 NO. Unit Cost Material Sub-Total Cost Unit Cost Labor Sub-Total Cost
 ONE (1) LOT
 LABOR AND MATERIALS FOR ENHANCEMENT OF STUDENT PARK AT FORTUNE-TOWNE CAMPUS
 SCOPE OF WORKS
 1.0 GENERAL REQUIREMENTS
 1.1 Mobilization and Demobilization
 1.2 Site Clearing, Cleaning, and Hauling of Site
 1.3 Installation of Scaffoldings (Rentals)
 1.4 Safety Occupational Hazzard
 2.0 STEEL AND ROOFING WORKS
 2.1 Fabrication and Installation of Shed House Steel Post, Roof Framing, and Roofing (6 units)
 3.0 PAINTING WORKS
 3.1 Surface Preparation and Painting of Shedhouse Steel Post and Roof Framing (3 coats)
 4.0 MISCELLANEOUS WORKS

BILL OF QUANTITIES

1.0 GENERAL REQUIREMENTS
 1.1 Mobilization and Demobilization 1.00 lot
 1.2 Site Clearing, Cleaning, and Hauling of Site 1.00 lot
 1.3 Scaffolding Rental 1.00 lot
 1.4 Safety Occupational Hazard 1.00 lot
 Sub-total, 1.0 (GENERAL REQUIREMENTS)
 2.0 STEEL AND ROOFING WORKS
 2.1 Fabrication and Installation of Shed House Steel Post, Roof Framing, and Roofing (6 units)
 2.1.1 3"Ø Shed. 40 G.I. Pipe @ 6m 6.00 lght
 2.1.2 2" x 4" x 1.2mm C- Purlins @ 6m 24.00 lght
 2.1.3 2" x 3" x 1.2mm C- Purlins @ 6m 24.00 lght
 2.1.4 0.40mm Pre-painted Spanish type Roofing Sheet 36.00 ln.m
 2.1.5 0.40mm Pre-painted Spanish type Ridge Roll Sheet 36.00 ln.m
 2.1.6 3/16" x 1" x 1" x 6m Angle Bar 6.00 lght
 2.1.7 2 1/2" full thread tekscrew 2.00 box
 2.1.8 1/8" x 1" Blind Rivets 1.00 box
 2.1.9 Welding Rod 2.00 kg
 2.1.10 Steel Cutting Disc 4.00 pcs
 Sub-total, 2.0 (STEEL AND ROOFING WORKS)
 3.0 PAINTING WORKS
 3.1 Surface Preparation and Painting of Shedhouse Steel Post and Roof Framing (3 coats)
 3.1.1 Epoxy paint primer "Zinc Chromate" 6.00 gal
 3.1.2 Epoxy Paint Topcoat "Zinc Chromate Gray" 6.00 gal
 3.1.3 Paint Thinner 4.00 gal
 3.1.4 Sandpaper # 120 5.00 pcs
 3.1.5 Sandpaper # 60 5.00 pcs
 3.1.6 Baby Roller 3.00 pcs
 3.1.7 Paint Brush 4" 3.00 pcs
 3.1.8 Paint Pan 3.00 pcs
 Sub-total, 3.0 (PAINTING WORKS)

4.0 MISCELLANEOUS WORKS

4.1 FOR ALL OTHER ITEMS that are not included on listed Bill of Quantities in your Bid, but tare deemed necessary for the completion of the works and the delivery of the project. 1.00 lot
 Sub-total, 4.0 (MISCELLANEOUS WORKS)
 PROJECT DURATION: 60 CALENDAR DAYS
 Note: Attach Certificate of Site Inspection

- A. TOTAL DIRECT COST
- B. CONSUMABLES:
- C. SUPERVISION AND ADMINISTRATION:
- D. TOTAL INDIRECT COST (B+C):
- E. TOTAL COST (A+D)
- F. VAT (12% OF ITEM E):

GRAND TOTAL OF PROJECT COST:
 *****NOTHING FOLLOWS*****

TOTAL ABC = Php 250,000.00
 PROCUREMENT OF LABOR AND MATERIALS FOR THE ENHANCEMENT OF STUDENT PARK AT FORTUNE TOWNE CAMPUS /R. TUBLE (Campus Executive Director)
 PR# 26-109-0225 02-25-26
 MDS 052-101-26-02 02-25-26

Line Items

Item No.	Product/Service Name	Description	Quantity	UOM	Budget (PHP)
1	ONE (1) LOT	Labor and Materials for the Enhancement of Student Park at Fortune-Towne Campus	1	Lot	250,000.00

Created by Rowena De la Vida Prado
Date Created 26/03/2026

The PhilGEPS team is not responsible for any typographical errors or misinformation presented in the system. PhilGEPS only displays information provided for by its clients, and any queries regarding the postings should be directed to the contact person/s of the concerned party.

© 2004-2026 DBM Procurement Service. All rights reserved.

[Help](#) | [Contact Us](#) | [Sitemap](#)



Republic of the Philippines
CARLOS HILADO MEMORIAL STATE UNIVERSITY
 Talisay City, Negros Occidental
 Mobile Phone Number: (0920) 583 3046
bac.sec@chmsu.edu.ph

REQUEST FOR QUOTATION

Page 1 of 4

Date: MARCH 25, 2026

Quotation No. 26-089

Please quote your lowest price on the item/s listed below, stating the shortest time of delivery and submit your quotation duly signed by your representative not later than _____ in the return envelope attached herewith.

DR. MA. RIZA T. MANALO
 BAC Chairperson

NOTE:

1. ALL ENTRIES MAY BE TYPEWRITTEN OR LEGIBLY HANDWRITTEN
2. DELIVERY PERIOD WITHIN 60 CALENDAR DAYS
3. WARRANTY SHALL BE FOR A PERIOD OF SIX (6) MONTHS FOR SUPPLIES & MATERIALS, ONE (1) YEAR FOR EQUIPMENT, FROM DATE OF ACCEPTANCE BY THE PROCURING ENTITY
4. PRICE VALIDITY SHALL BE FOR A PERIOD OF _____ CALENDAR DAYS
5. G-EPS REGISTRATION CERTIFICATE SHALL BE ATTACHED UPON SUBMISSION OF THE QUOTATION
6. BIDDERS SHALL SUBMIT ORIGINAL BROCHURES SHOWING CERTIFICATIONS OF THE PRODUCT BEING OFFERED

ITEM NO.	DESCRIPTION OF WORKS	QTY.	UNIT	MATERIAL COST		LABOR COST		TOTAL COST
				Unit Cost	Material Sub-Total Cost	Unit Cost	Labor Sub-Total Cost	
	ONE (1) LOT							
	LABOR AND MATERIALS FOR ENHANCEMENT OF STUDENT PARK AT FORTUNE-TOWNE CAMPUS							
	SCOPE OF WORKS							
1.0	GENERAL REQUIREMENTS							
1.1	Mobilization and Demobilization							
1.2	Site Clearing, Cleaning, and Hauling of Site							
1.3	Installation of Scaffoldings (Rentals)							
1.4	Safety Occupational Hazzard							
2.0	STEEL AND ROOFING WORKS							
2.1	Fabrication and Installation of Shed House Steel Post, Roof Framing, and Roofing (6 units)							
3.0	PAINTING WORKS							
3.1	Surface Preparation and Painting of Shedhouse Steel Post and Roof Framing (3 coats)							
4.0	MISCELLANEOUS WORKS							
	BILL OF QUANTITIES							
1.0	GENERAL REQUIREMENTS							
1.1	Mobilization and Demobilization	1.00	lot					

Date

By

Released (BAC) _____
 Returned (Supplier) _____

Printed Name/Signature

Tel. No./Cellphone No.

Date



Republic of the Philippines
CARLOS HILADO MEMORIAL STATE UNIVERSITY
Talisay City, Negros Occidental
Mobile Phone Number: (0920) 583 3046
bac.sec@chmsu.edu.ph

REQUEST FOR QUOTATION

Page 2 of 4

Date: MARCH 25, 2026
Quotation No. 26-089

Please quote your lowest price on the item/s listed below, stating the shortest time of delivery and submit your quotation duly signed by your representative not later than _____ in the return envelope attached herewith.

DR. MA. RIZA T. MANALO
BAC Chairperson

NOTE:

1. ALL ENTRIES MAY BE TYPEWRITTEN OR LEGIBLY HANDWRITTEN
2. DELIVERY PERIOD WITHIN 60 CALENDAR DAYS
3. WARRANTY SHALL BE FOR A PERIOD OF SIX (6) MONTHS FOR SUPPLIES & MATERIALS, ONE (1) YEAR FOR EQUIPMENT, FROM DATE OF ACCEPTANCE BY THE PROCURING ENTITY
4. PRICE VALIDITY SHALL BE FOR A PERIOD OF _____ CALENDAR DAYS
5. G-EPS REGISTRATION CERTIFICATE SHALL BE ATTACHED UPON SUBMISSION OF THE QUOTATION
6. BIDDERS SHALL SUBMIT ORIGINAL BROCHURES SHOWING CERTIFICATIONS OF THE PRODUCT BEING OFFERED

ITEM NO.	DESCRIPTION OF WORKS	QTY.	UNIT	MATERIAL COST		LABOR COST		TOTAL COST
				Unit Cost	Material Sub-Total Cost	Unit Cost	Labor Sub-Total Cost	
1.2	Site Clearing, Cleaning, and Hauling of Site	1.00	lot					
1.3	Scaffolding Rental	1.00	lot					
1.4	Safety Occupational Hazard	1.00	lot					
	Sub-total, 1.0 (GENERAL REQUIREMENTS)							
2.0	STEEL AND ROOFING WORKS							
2.1	Fabrication and Installation of Shed House Steel Post, Roof Framing, and Roofing (6 units)							
2.1.1	3"Ø Shed. 40 G.I. Pipe @ 6m	6.00	lght					
2.1.2	2" x 4" x 1.2mm C- Purlins @ 6m	24.00	lght					
2.1.3	2" x 3" x 1.2mm C- Purlins @ 6m	24.00	lght					
2.1.4	0.40mm Pre-painted Spanish type Roofing Sheet	36.00	In.m					
2.1.5	0.40mm Pre-painted Spanish type Ridge Roll Sheet	36.00	In.m					
2.1.6	3/16" x 1" x 1" x 6m Angle Bar	6.00	lght					
2.1.7	2 1/2" full thread tekscrew	2.00	box					
2.1.8	1/8" x 1" Blind Rivets	1.00	box					

Date

By

Released (BAC) _____
Returned (Supplier) _____

Printed Name/Signature

Tel. No./Cellphone No.

Date



Republic of the Philippines
CARLOS HILADO MEMORIAL STATE UNIVERSITY
 Talisay City, Negros Occidental
 Mobile Phone Number: (0920) 583 3046
bac.sec@chmsu.edu.ph

REQUEST FOR QUOTATION

Page 3 of 4

Date: MARCH 25, 2026
 Quotation No. 26-089

Please quote your lowest price on the item/s listed below, stating the shortest time of delivery and submit your quotation duly signed by your representative not later than _____ in the return envelope attached herewith.

DR. MA. RIZA T. MANALO
 BAC Chairperson

NOTE:

1. ALL ENTRIES MAY BE TYPEWRITTEN OR LEGIBLY HANDWRITTEN
2. DELIVERY PERIOD WITHIN 60 CALENDAR DAYS
3. WARRANTY SHALL BE FOR A PERIOD OF SIX (6) MONTHS FOR SUPPLIES & MATERIALS, ONE (1) YEAR FOR EQUIPMENT, FROM DATE OF ACCEPTANCE BY THE PROCURING ENTITY
4. PRICE VALIDITY SHALL BE FOR A PERIOD OF _____ CALENDAR DAYS
5. G-EPS REGISTRATION CERTIFICATE SHALL BE ATTACHED UPON SUBMISSION OF THE QUOTATION
6. BIDDERS SHALL SUBMIT ORIGINAL BROCHURES SHOWING CERTIFICATIONS OF THE PRODUCT BEING OFFERED

ITEM NO.	DESCRIPTION OF WORKS	QTY.	UNIT	MATERIAL COST		LABOR COST		TOTAL COST
				Unit Cost	Material Sub-Total Cost	Unit Cost	Labor Sub-Total Cost	
2.1.9	Welding Rod	2.00	kg					
2.1.10	Steel Cutting Disc	4.00	pcs					
	Sub-total, 2.0 (STEEL AND ROOFING WORKS)							
3.0	PAINTING WORKS							
3.1	Surface Preparation and Painting of Shedhouse Steel Post and Roof Framing (3 coats)							
3.1.1	Epoxy paint primer "Zinc Chromate"	6.00	gal					
3.1.2	Epoxy Paint Top Coat "Zinc Chromate Gray"	6.00	gal					
3.1.3	Paint Thinner	4.00	gal					
3.1.4	Sandpaper # 120	5.00	pcs					
3.1.5	Sandpaper # 60	5.00	pcs					
3.1.6	Baby Roller	3.00	pcs					
3.1.7	Paint Brush 4"	3.00	pcs					
3.1.8	Paint Pan	3.00	pcs					
	Sub-total, 3.0 (PAINTING WORKS)							
4.0	MISCELLANEOUS WORKS							
4.1	FOR ALL OTHER ITEMS that are not included on listed Bill of Quantities in your Bid but are deemed necessary for the completion of the works and the delivery of the project.	1.00	lot					
	Sub-total, 4.0 (MISCELLANEOUS WORKS)							

Date _____ By _____

Released (BAC) _____
 Returned (Supplier) _____

Printed Name/Signature

Tel. No./Cellphone No.

Date



Republic of the Philippines
CARLOS HILADO MEMORIAL STATE UNIVERSITY
 Talisay City, Negros Occidental
 Mobile Phone Number: (0920) 583 3046
bac.sec@chmsu.edu.ph

REQUEST FOR QUOTATION

Page 4 of 4

Date: MARCH 25, 2026
 Quotation No. 26-089

Please quote your lowest price on the item/s listed below, stating the shortest time of delivery and submit your quotation duly signed by your representative not later than _____ in the return envelope attached herewith.

DR. MA. RIZA T. MANALO
 BAC Chairperson

NOTE:

1. ALL ENTRIES MAY BE TYPEWRITTEN OR LEGIBLY HANDWRITTEN
2. DELIVERY PERIOD WITHIN 60 CALENDAR DAYS
3. WARRANTY SHALL BE FOR A PERIOD OF SIX (6) MONTHS FOR SUPPLIES & MATERIALS, ONE (1) YEAR FOR EQUIPMENT, FROM DATE OF ACCEPTANCE BY THE PROCURING ENTITY
4. PRICE VALIDITY SHALL BE FOR A PERIOD OF _____ CALENDAR DAYS
5. G-EPS REGISTRATION CERTIFICATE SHALL BE ATTACHED UPON SUBMISSION OF THE QUOTATION
6. BIDDERS SHALL SUBMIT ORIGINAL BROCHURES SHOWING CERTIFICATIONS OF THE PRODUCT BEING OFFERED

ITEM NO.	DESCRIPTION OF WORKS	QTY.	UNIT	MATERIAL COST		LABOR COST		TOTAL COST
				Unit Cost	Material Sub-Total Cost	Unit Cost	Labor Sub-Total Cost	
	PROJECT DURATION: 60 CALENDAR DAYS							
	Note: Attach Certificate of Site Inspection							
	A. TOTAL DIRECT COST							
	B. CONSUMABLES:							
	C. SUPERVISION AND ADMINISTRATION:							
	D. TOTAL INDIRECT COST (B+C):							
	E. TOTAL COST (A+D)							
	F. VAT (12% OF ITEM E):							
	GRAND TOTAL OF PROJECT COST:							
	*****NOTHING FOLLOWS*****							
	TOTAL ABC = Php 250,000.00							
	PROCUREMENT OF LABOR AND MATERIALS FOR THE ENHANCEMENT OF STUDENT PARK AT FORTUNE TOWNE CAMPUS /R. TUBLE (Campus Executive Director)							
	PR# 26-109-0225 02-25-26							
	MDS 052-101-26-02 02-25-26							

Date

By

Released (BAC) _____
 Returned (Supplier) _____

Printed Name/Signature

Tel. No./Cellphone No.

Date



THIS SITE

SITE DEVELOPMENT PLAN
SCALE NDTs

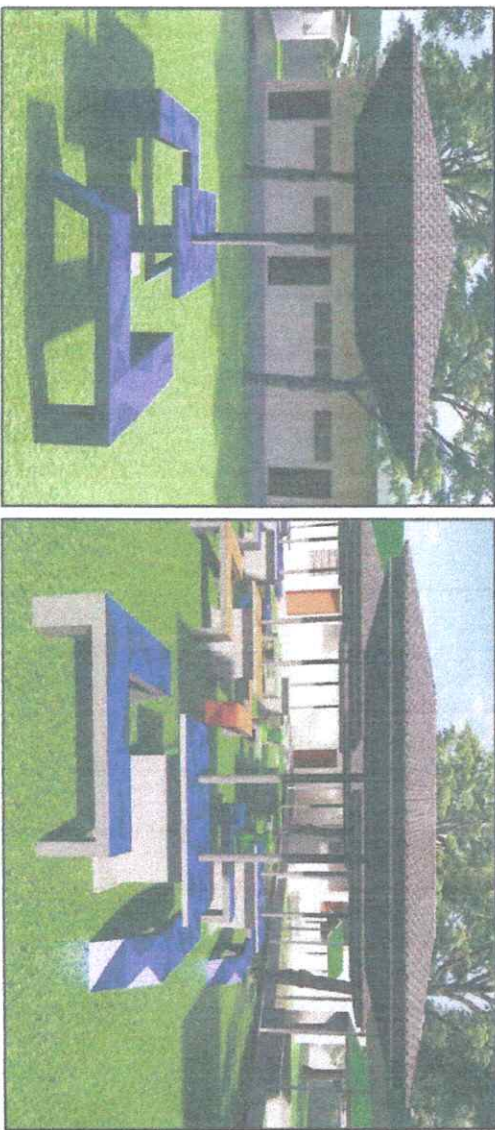





EXTERIOR PERSPECTIVE
SCALE NDTs

 <p>Republic of the Philippines CARLOS M. DELGADO MEMORIAL STATE UNIVERSITY Maguindanao</p>		<p>PROJECT TITLE: ENHANCEMENT OF STUDENT PARK</p>		<p>ENDORSED BY: RUBY H. TUBLE, PH.D.</p>		<p>PREPARED BY: JAY B. ERELLAS, Ed.D.</p>		<p>CHECKED BY: M. A. ANTONIO, Ed.D.</p>		<p>RECOMMENDING APPROVAL: JAY B. ERELLAS, Ed.D.</p>		<p>APPROVED BY: NORBERT P. MANGULABMAN, PH.D.</p>		<p>SHEET NO.: CS</p>		<p>PAGE NO.: 1 / 3</p>	
<p>OFFICE OF THE PROJECT MANAGEMENT UNIT</p>				<p>PROJECT LOCATION: FORTUNE TOWNE CAMPUS</p>				<p>DESIGNING ENGINEER: FORTUNE TOWNE CAMPUS</p>				<p>MAIN CONTRACTOR: FORTUNE TOWNE CAMPUS</p>					

2/4/20 9:20



EXISTING PHOTOS OF STUDENT PARK

 <p>Republic of the Philippines CARLOS HILADO MEMORIAL STATE UNIVERSITY Region Occidental</p>		<p>PROJECT TITLE: ENHANCEMENT OF STUDENT PARK</p>		<p>ENDORSED BY:  RUVIE M. TURGE, Ph.D. <small>EXECUTIVE DIRECTOR, FORMINE TOWNE CAMPUS</small></p>		<p>PREPARED BY: HANDWRITING STAFF <small>UNIVERSITY BARRACKS, FORMINE TOWNE CAMPUS</small> ENGR. GABRIEL M. LONDADO JR. <small>CHIEF OFFICER IN CHARGE, PROJECT MANAGEMENT UNIT, FORMINE TOWNE</small></p>		<p>CHECKED BY:  <small>PROJECT MANAGEMENT OFFICER</small> ANGELINA M. MARIANO <small>PROJECT MANAGEMENT OFFICER III</small></p>		<p>RECOMMENDING APPROVAL:  EVAN JUN-JUN J. MARQUEZ <small>DIRECTOR, PROJECT MANAGEMENT UNIT</small></p>		<p>APPROVED BY:  NORBERTO P. MANGULABNAN, Ph.D. <small>SUC PRESIDENT III</small></p>		<p>SHEET NO: A</p>		<p>PAGE NO: 2 3</p>	
---	--	--	--	--	--	---	--	--	--	---	--	--	--	---------------------------------------	--	--	--

OFFICE OF THE PROJECT MANAGEMENT UNIT

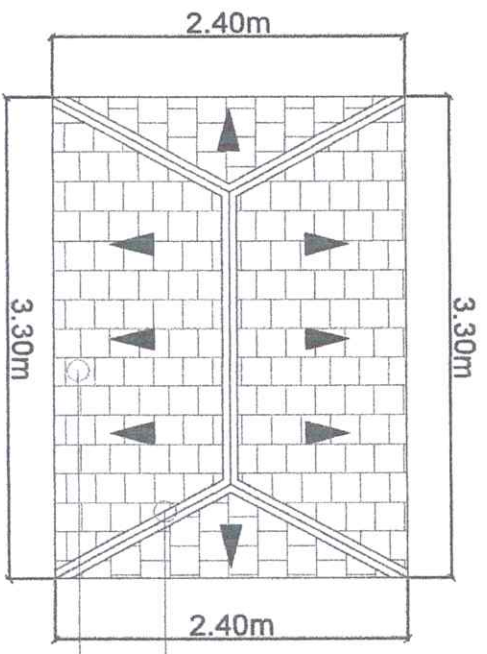

ROOF PLAN
SCALE 1:50 MTS

2" X 4" C-PURLINS
2" X 3" C-PURLINS
SPANISH TYPE RIDGE
ROLL (PRE-PAINTED)
SPANISH ROOF SHEET
(PRE-PAINTED)

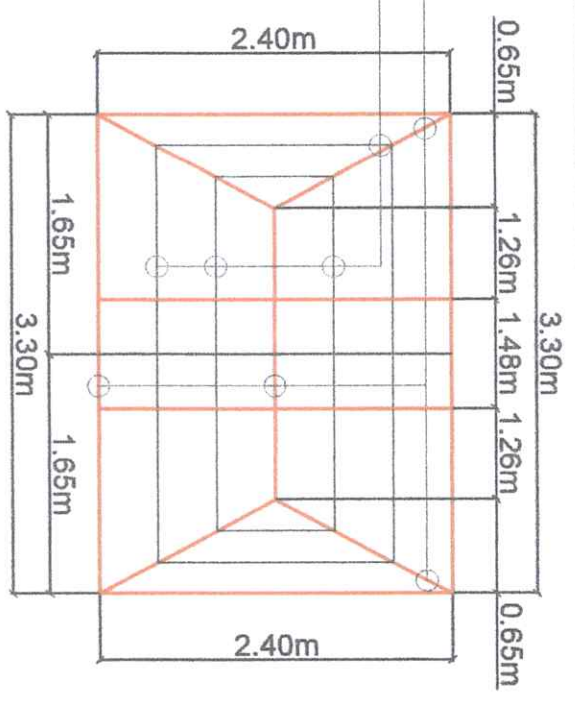

ROOF FRAMING PLAN
SCALE 1:50 MTS

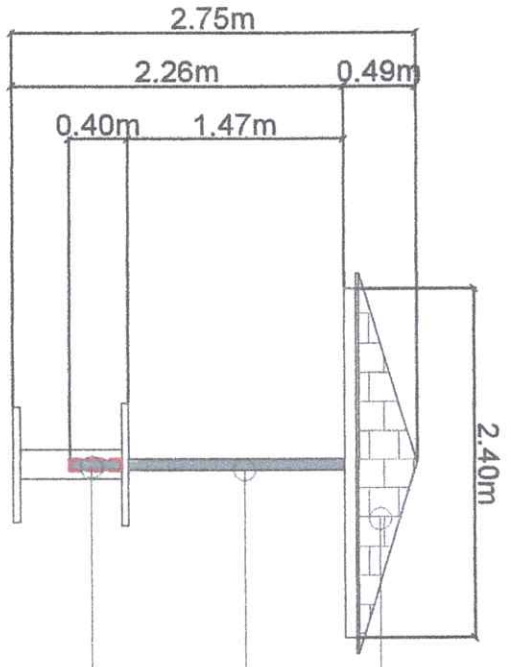

FRONT VIEW

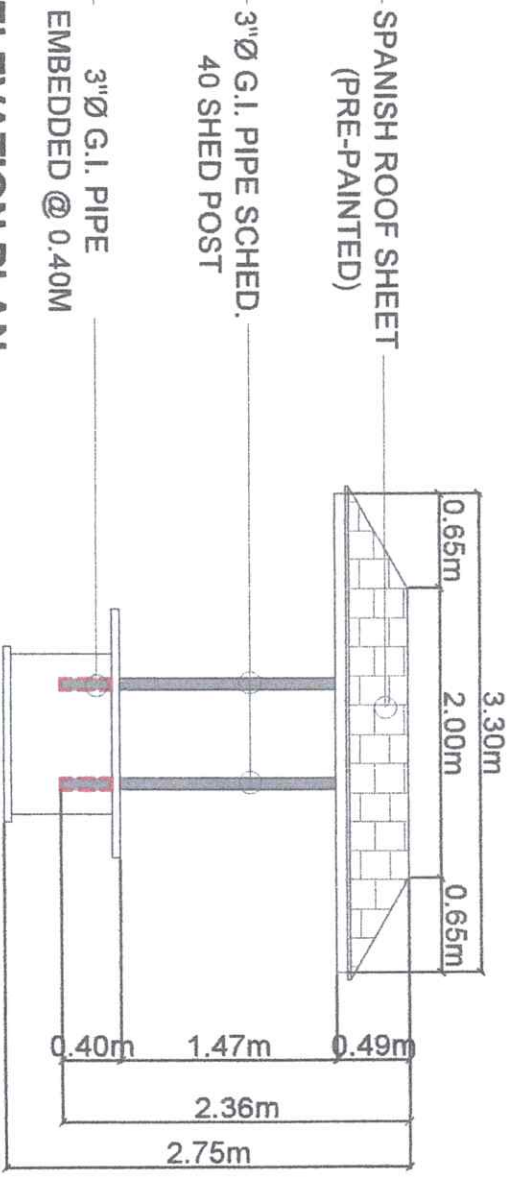

ELEVATION PLAN
SCALE 1:50 MTS

SPANISH ROOF SHEET
(PRE-PAINTED)
3"Ø G.I. PIPE SCHED.
40 SHED POST
3"Ø G.I. PIPE
EMBEDDED @ 0.40M

RIGHT-SIDE VIEW



Republic of the Philippines CARLOS HILADO MEMORIAL STATE UNIVERSITY Region Occidental		PROJECT TITLE ENHANCEMENT OF STUDENT PARK		ENDORSED BY: RIVERA, T. L. M., Ph.D.		PREPARED BY: FERRER, J. M. S., Ph.D.		CHECKED BY: ARRIAGA, M. S., Ph.D.		RECOMMENDING APPROVAL: ENRIQUE, J. M. S., Ph.D.		APPROVED BY: NORBERTO P. MANGILABAN, Ph.D.		SHEET NO.: A		PAGE NO.: 3 / 3	
OFFICE OF THE PROJECT MANAGEMENT UNIT		PROJECT LOCATION: FORTUNE TOWNE CAMPUS		XACHTER'S STAND ON FORTUNE TOWNE CAMPUS		UNIVERSITY BARRACKS, 1st FLOOR FORTUNE TOWNE CAMPUS		ASST. CHIEF OF STAFF		DIRECTOR, PROJECT MANAGEMENT UNIT		VICE PRESIDENT FOR ADMINISTRATION		SUC PRESIDENT III			